



**NEW  
FOR 2025!**



# COLOR SELECTIONS

## STANDARD COLOR SCHEMES



Cedar

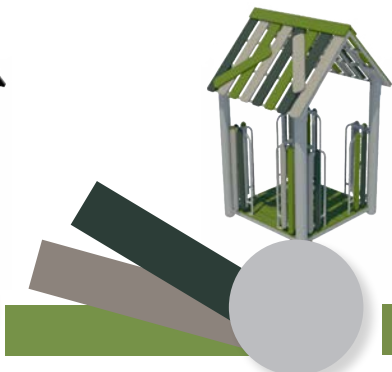

Moss

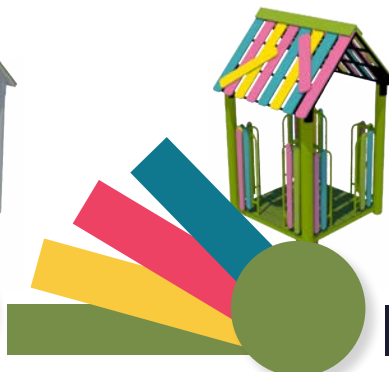

Meadow

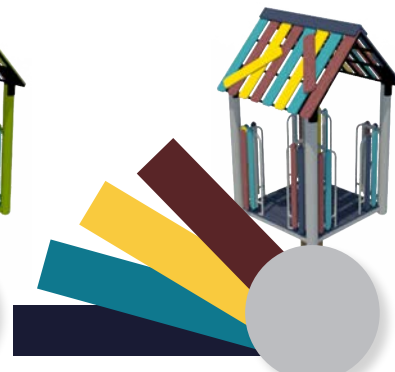

Reef

## METALS



## SLIDES



## NETS

\*Black and Tan are Standard. More colors available as a special request.



Other colors may be available as a special order.  
Additional cost and lead time may be required for non-standard





# PANELS

## EDUCATIONAL PANELS

\*samples shown, more available



## ACTIVITY PANELS

\*samples shown, more available



# What's NEW with



## Powder Coated Finishes

Powder coating offers several benefits, including increased durability, a smooth and even finish, and resistance to corrosion, scratches, and fading. Powder coating is highly resistant to weather elements, making it an ideal choice for outdoor applications, where long-lasting protection is essential.

## Expanded Decking Colors

Colorful Recycled Plastic decking offers an aesthetic advantage when the goal is a more vibrant, eye-catching play environment. Whereas traditional brown colors are great at blending into the surrounding area, our new bright color schemes engage children and create visually striking outdoor spaces.

## More Play, More Materials

GFRC is a creatively flexible and dynamic material that allows for maximum customization; however, the added weight, size and cost of the product can restrict its ability to be used in every situation. Our new, cost-effective climbers are made from a variety of materials, allowing the end user more flexibility in their budget. This also has the added benefit of reducing the overall weight of the system, allowing for an easier install and more play per dollar!



**MODEL #** T2-201  
**AGE GROUP** 2-5  
**FALL HEIGHT** 48"  
**REQ. AREA** 43'-9" X 26'-9"  
**COLOR SCHEME** Meadow

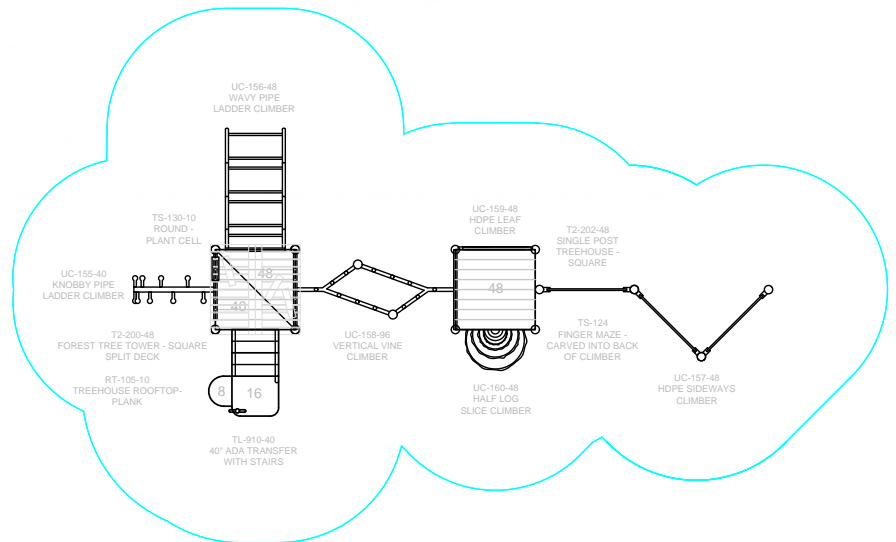

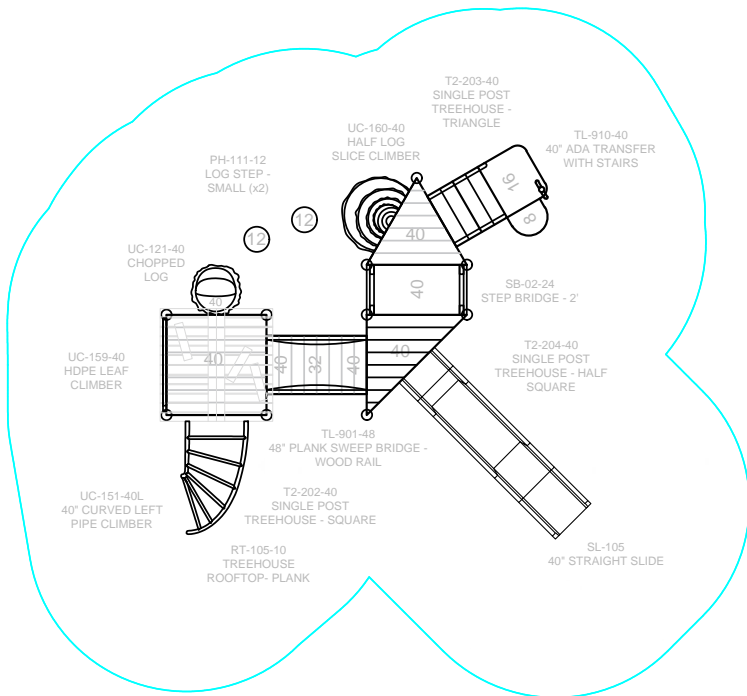

**MODEL #** T2-202  
**AGE GROUP** 2-5  
**FALL HEIGHT** 40"  
**REQ. AREA** 31'-9" X 28'-3"  
**COLOR SCHEME** Reef

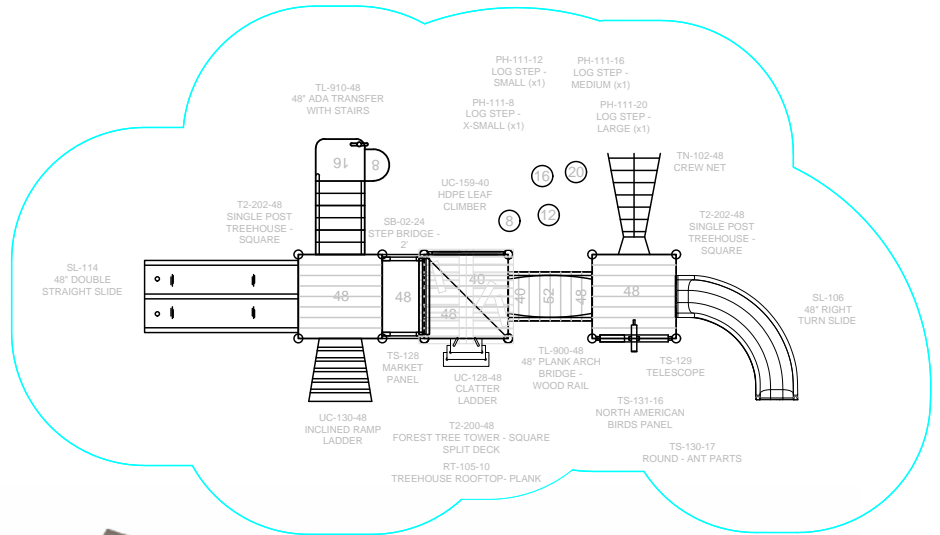

**MODEL #** T2-203  
**AGE GROUP** 2-12  
**FALL HEIGHT** 56"  
**REQ. AREA** 26'-11" X 43'-9"  
**COLOR SCHEME** Cedar



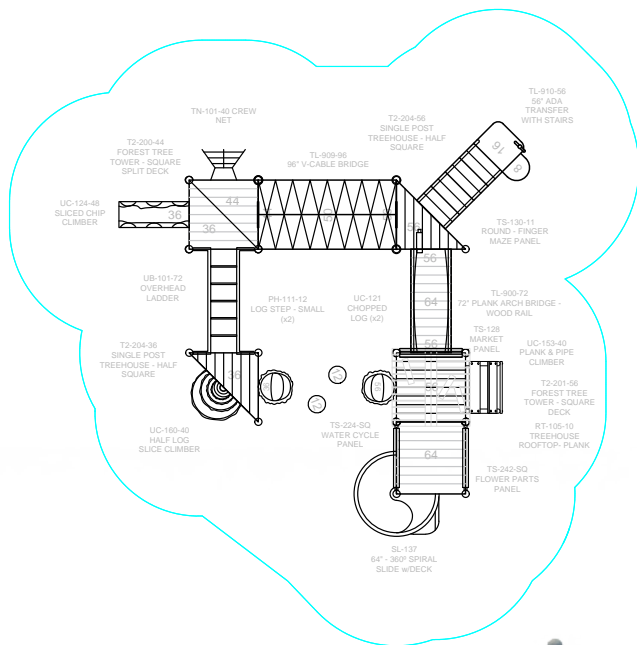

**MODEL #** T2-204  
**AGE GROUP** 2-12  
**FALL HEIGHT** 64"  
**REQ. AREA** 36'-5" X 37'-9"  
**COLOR SCHEME** Moss





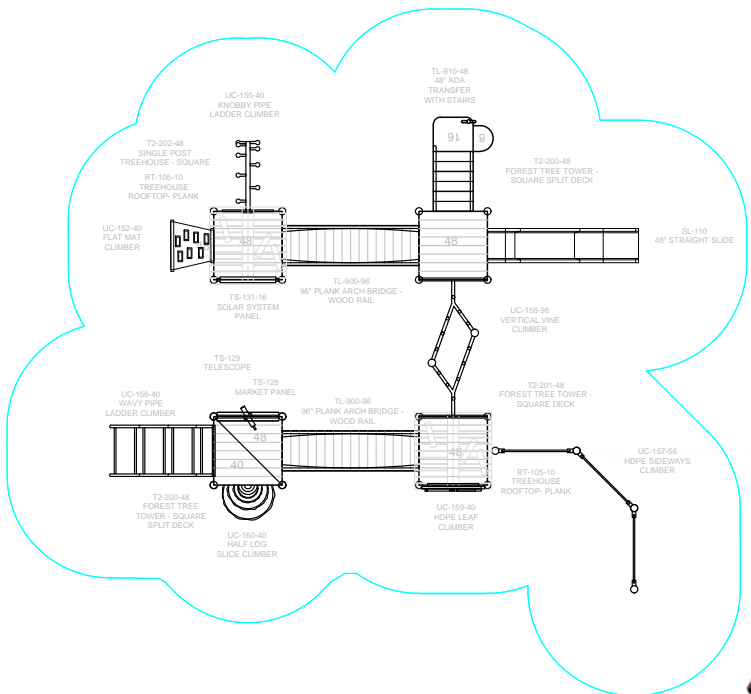

**MODEL #** T2-205  
**AGE GROUP** 5-12  
**FALL HEIGHT** 64"  
**REQ. AREA** 26'-11" X 43'-9"  
**COLOR SCHEME** Reef



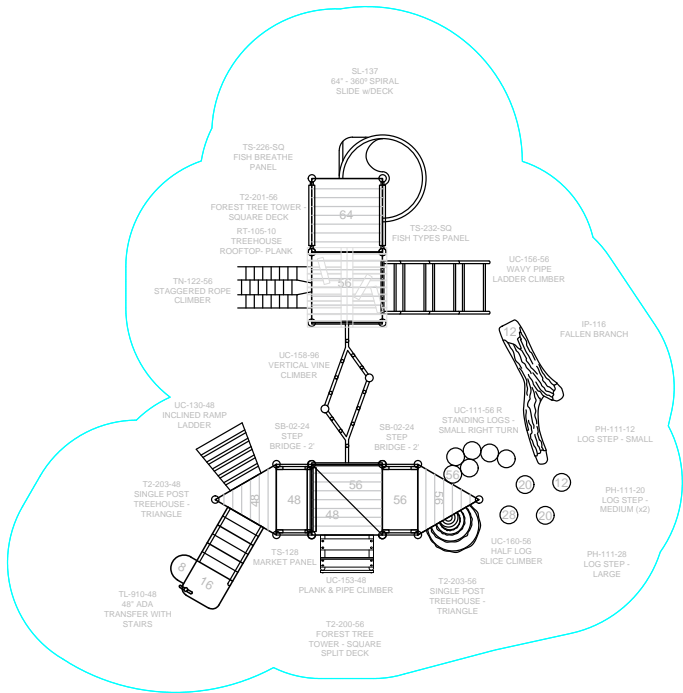

**MODEL #** T2-206  
**AGE GROUP** 2-12  
**FALL HEIGHT** 64"  
**REQ. AREA** 38'-10" X 38'-2"  
**COLOR SCHEME** Cedar

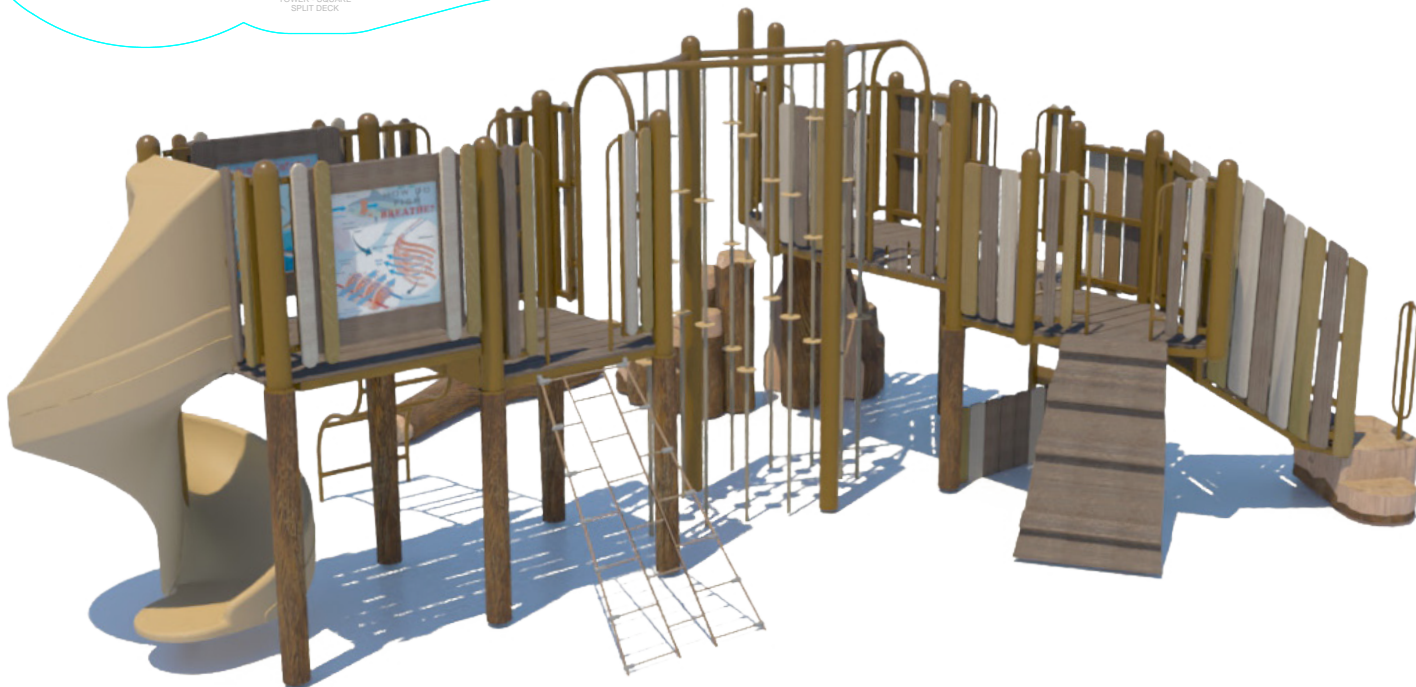



**MODEL #** T2-207  
**AGE GROUP** 2-12  
**FALL HEIGHT** 64"  
**REQ. AREA** 38'-10" X 38'-2"  
**COLOR SCHEME** Meadow

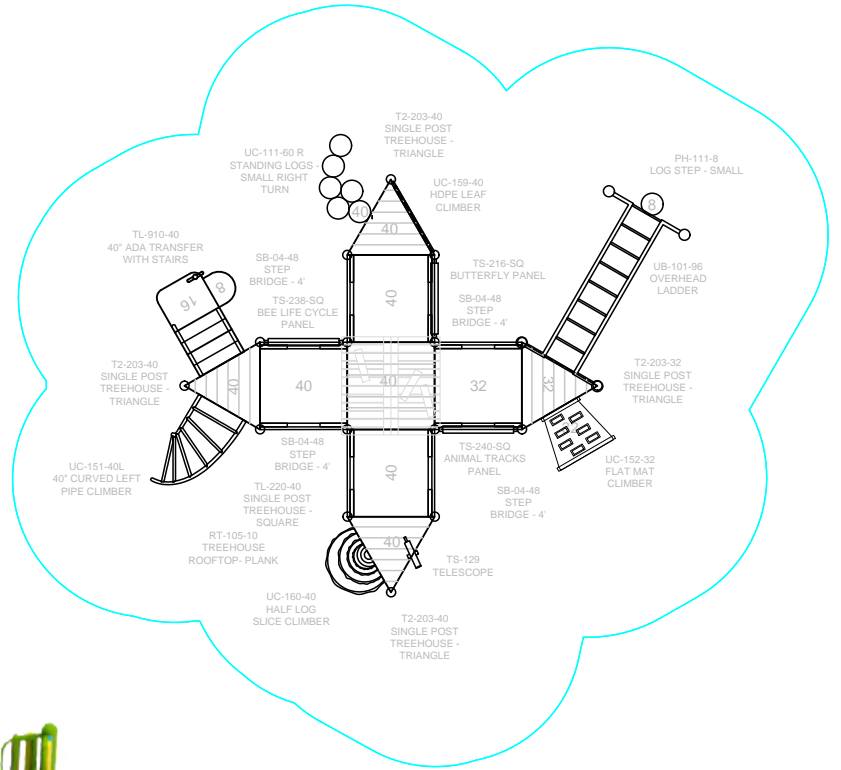



**MODEL #** T2-208  
**AGE GROUP** 2-12  
**FALL HEIGHT** 60"  
**REQ. AREA** 55'-2" X 53'  
**COLOR SCHEME** Reef

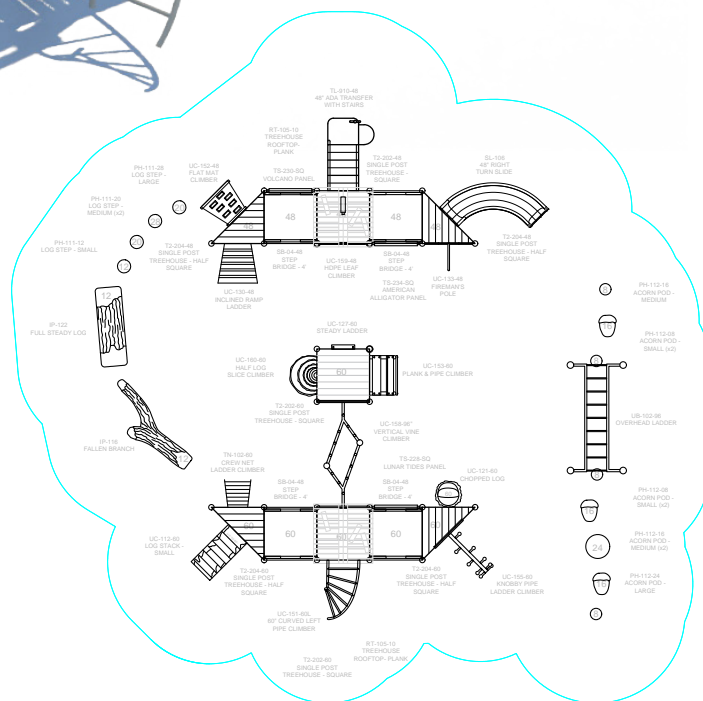



**UC-155**  
**KNOBBY PIPE CLIMBER**  
**HEIGHTS** 24"-60"



**UC-157**  
**SIDESTEP WALL CLIMBER**  
**HEIGHTS** 30"-72"



**UC-151**  
**HELIX PIPE CLIMBER**  
**HEIGHTS** 30"-72"



**UC-152**  
**FLAT MAT CLIMBER**  
**HEIGHTS** 30" - 80"



**UC-153**  
**PLANK AND PIPE CLIMBER**  
**HEIGHTS** 24"-88"



**UC-156**  
**WAVY PIPE CLIMBER**  
**HEIGHTS** 24" - 88"



**UC-158**  
**VERTICAL VINE TREK**  
**HEIGHTS** 60"-96"



**UC-159**  
**HDPE LEAF CLIMBER**  
**HEIGHTS** 24"-96"



**UC-160**  
**HALF LOG STEP CLIMBER**  
**HEIGHTS** 24"-72"

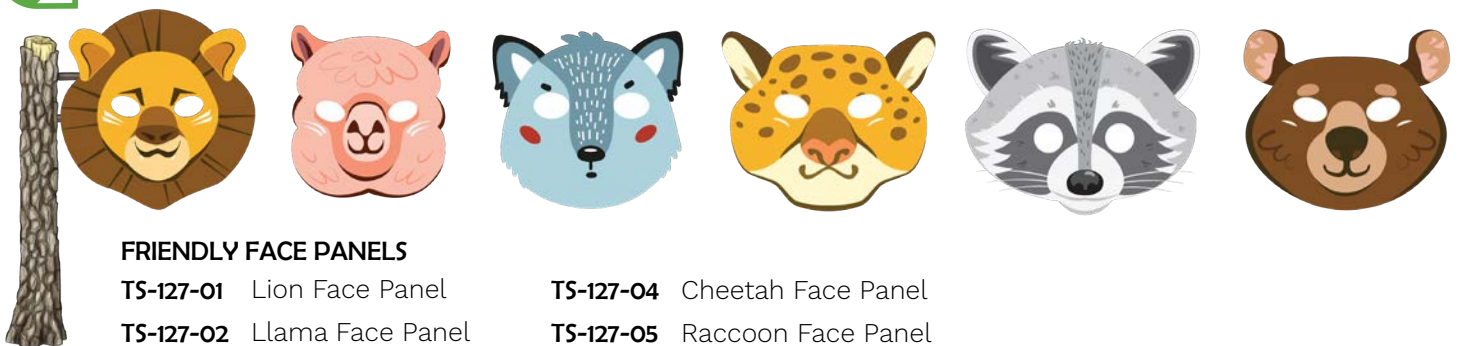

**FRIENDLY FACE PANELS**

**TS-127-01** Lion Face Panel

**TS-127-02** Llama Face Panel

**TS-127-03** Wolf Face Panel

**TS-127-04** Cheetah Face Panel

**TS-127-05** Raccoon Face Panel

**TS-127-06** Bear Face Panel



Submit a New  
Design Request Here!

Playit  
Creations

5100 130 Street N • Hugo, MN 55038  
888-7-PLAYIT

[www.playitcreations.com](http://www.playitcreations.com)